

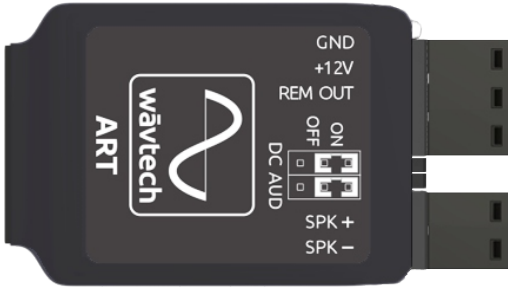

ART

Auto Remote Turn-On



The ART (Auto Remote Turn-On) provides a simple solution for generating a switched +12V trigger for turning on system components or to power small electronics directly such as radar detectors or dash-cams. With up to 1.5A continuous output current, the ART can also drive multiple relays simultaneously, such as for rear-seat monitors or lighting.

Consider the ART as huge time-saver for vehicles where a switched +12V wire is not available, or would take significant labor find and/or access one. The ART utilizes the exact same circuitry found in our best-in-class LOC's, the most reliable auto turn-on sensing system on the market. Simply connect to power and ground and tap into any easily accessible +/- speaker wires in the vehicle.

Wiring Example

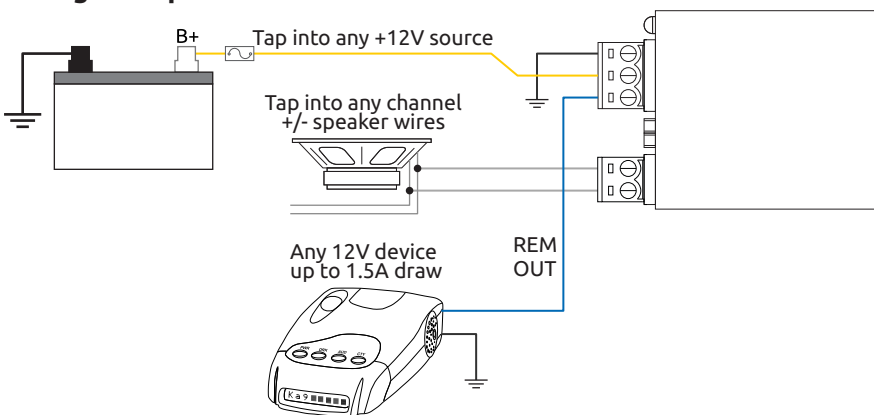

Notes:

- Speaker wire polarity doesn't matter for DC-offset or Audio detect to function
- Blue LED will illuminate when the ART is generating a +12V output via the REM OUT terminal
- Both DC-offset and Audio detect jumpers are set to ON by factory default

Specifications

Operating Supply Voltage	10- 18VDC
DC-Offset Detect Threshold	>1.3VDC
Audio Detect Threshold	<80mV
Idle Current Draw (no load)	<35mA
Sleep Current Draw	<1.7mA
Rem Output Current Capacity	1.5A
Rem Output Voltage (max load)	<10% from B+
Recommended Fuse Rating	2A

Connections & Settings

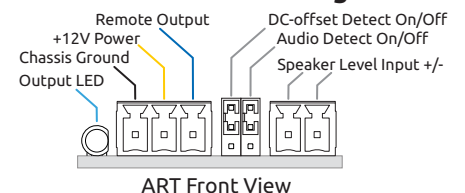

Automatic Signal Sense for DC-offset and/or Audio Signal • Generated +12V Remote Output
Up to 1.5A Continuous Output Current • Locking Detachable Terminals